

Commonwealth of Massachusetts
METROPOLITAN DISTRICT COMMISSION
PARKS DIVISION

BLUE HILLS PARKWAY
PLAN OF LAND AT
MATTAPAN SQUARE, BOSTON
TO BE CONVEYED TO

LOUIS L. AUGUST

Scale 1" = 20' June 16, 1950

Benjamin M. Fink
Director of Park Engineering

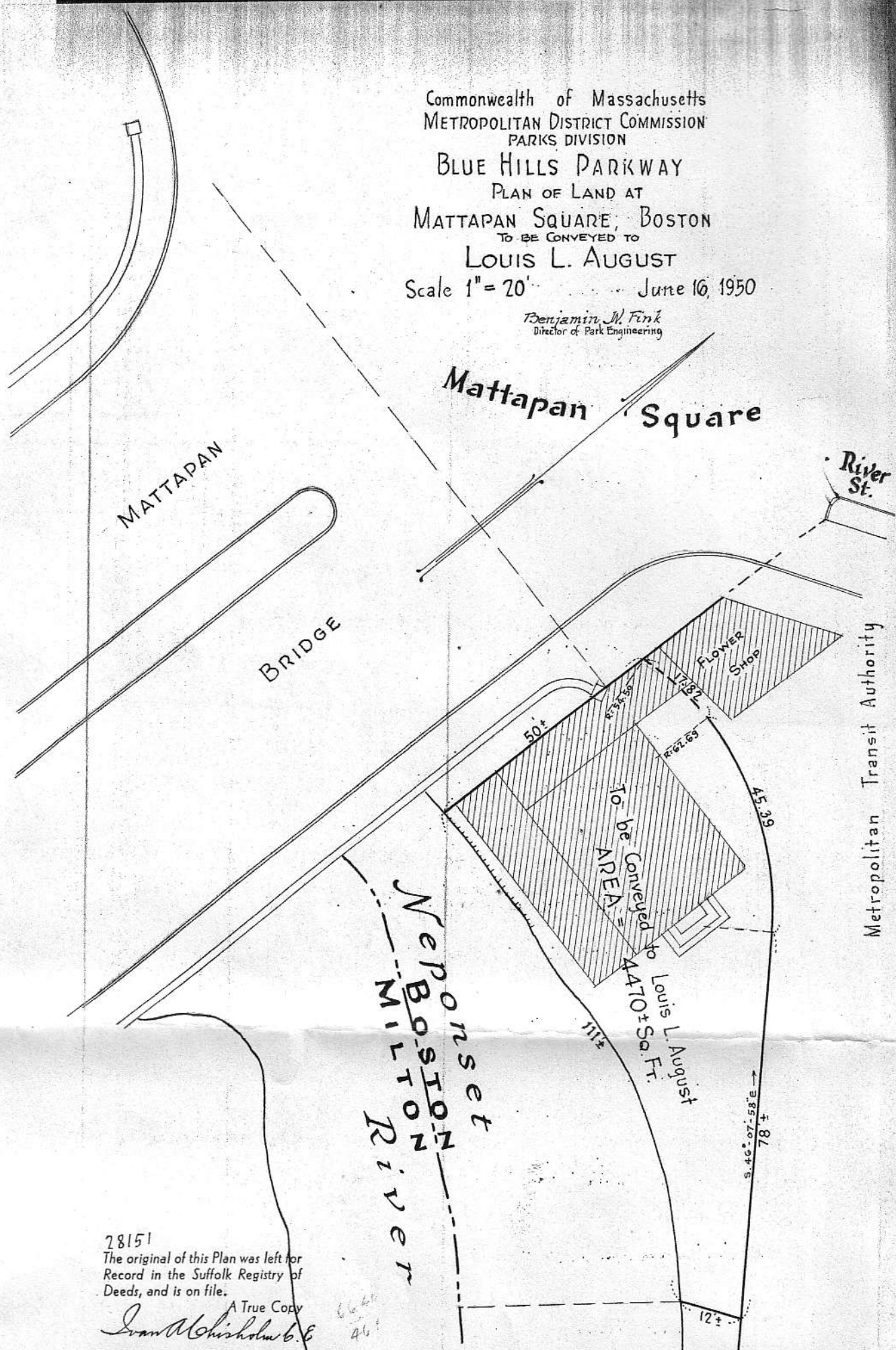

28151
The original of this Plan was left for
Record in the Suffolk Registry of
Deeds, and is on file.

A True Copy
Ivan M. Whisholm C.E.