

AS PLAN WAS PREPARED IN ACCORDANCE WITH THE
 RULES AND REGULATIONS FOR RECORDING, ADOPTED BY
 THE REGISTER OF DEEDS IN 1978 AND AMENDED
 JANUARY 12, 1988.

Walter S. Dwyer, Jr.
 PROFESSIONAL LAND SURVEYOR
 FOR OTTE & DWYER, INC.

Walter S. Dwyer, Jr.
 PROFESSIONAL LAND SURVEYOR
 FOR OTTE & DWYER, INC.

I HEREBY CERTIFY THAT THIS PLAN FULLY AND ACCURATELY DEPICTS
 THE LAYOUT, LOCATION, UNIT NUMBER AND DIMENSIONS OF THE UNITS
 SHOWN AT THE NEWMARKET CONDOMINIUM, AS BUILT.

DETAIL OF STORAGE LOFT AREA
 ABOVE COMMON METER/MECHANICAL ROOM

STORAGE LOFT (EXCL. USE UNIT 25)

ACCESS DOOR

COMMON METER/MECHANICAL ROOM

EXCLUSIVE STORAGE USE (UNIT 140) 8' X 10'

37'-9"

UNIT 25

PROCESSING AREA

28'-8"

REFRIGERATOR

12'-2"

FREEZER

24'-9"

PROCESSING AREA

37'-6"

MATCH LINE

WEST END

EAST END

WEST END MAIN FLOOR - UNIT 25

EAST END AND WEST END COMBINED AREA 7,972± s.f.

CONDOMINIUM FLOOR PLAN

NEWMARKET CONDOMINIUM

LOCATED AT

19-25 HOWARD STREET

140 HAMPDEN STREET

ROXBURY, BOSTON, MASS.

BY

Otte & Dwyer, Jr.

LAND SURVEYORS

196 CENTRAL STREET SAUGUS, MASS.

P.O. BOX 982 (781) 233-8155

SCALE: 1/8" = 1' NOVEMBER 11, 2008

REVISED: 12-13-05 FINAL REVISIONS.

0 8 16 24

SCALE

WEST END MAIN FLOOR - UNIT 25

EAST END AND WEST END COMBINED AREA 7,972± s.f.

CONDOMINIUM FLOOR PLAN

NEWMARKET CONDOMINIUM

LOCATED AT

19-25 HOWARD STREET

140 HAMPDEN STREET

ROXBURY, BOSTON, MASS.

BY

Otte & Dwyer, Jr.

LAND SURVEYORS

196 CENTRAL STREET SAUGUS, MASS.

P.O. BOX 982 (781) 233-8155

SCALE: 1/8" = 1' NOVEMBER 11, 2008

REVISED: 12-13-05 FINAL REVISIONS.

0 8 16 24

SCALE

WEST END MAIN FLOOR - UNIT 25

EAST END AND WEST END COMBINED AREA 7,972± s.f.

CONDOMINIUM FLOOR PLAN

NEWMARKET CONDOMINIUM

LOCATED AT

19-25 HOWARD STREET

140 HAMPDEN STREET

ROXBURY, BOSTON, MASS.

BY

Otte & Dwyer, Jr.

LAND SURVEYORS

196 CENTRAL STREET SAUGUS, MASS.

P.O. BOX 982 (781) 233-8155

SCALE: 1/8" = 1' NOVEMBER 11, 2008

REVISED: 12-13-05 FINAL REVISIONS.

0 8 16 24

SCALE

WEST END MAIN FLOOR - UNIT 25

EAST END AND WEST END COMBINED AREA 7,972± s.f.

CONDOMINIUM FLOOR PLAN

NEWMARKET CONDOMINIUM

LOCATED AT

19-25 HOWARD STREET

140 HAMPDEN STREET

ROXBURY, BOSTON, MASS.

BY

Otte & Dwyer, Jr.

LAND SURVEYORS

196 CENTRAL STREET SAUGUS, MASS.

P.O. BOX 982 (781) 233-8155

SCALE: 1/8" = 1' NOVEMBER 11, 2008

REVISED: 12-13-05 FINAL REVISIONS.

0 8 16 24

SCALE

WEST END MAIN FLOOR - UNIT 25

EAST END AND WEST END COMBINED AREA 7,972± s.f.

CONDOMINIUM FLOOR PLAN

NEWMARKET CONDOMINIUM

LOCATED AT

19-25 HOWARD STREET

140 HAMPDEN STREET

ROXBURY, BOSTON, MASS.

BY

Otte & Dwyer, Jr.

LAND SURVEYORS

196 CENTRAL STREET SAUGUS, MASS.

P.O. BOX 982 (781) 233-8155

SCALE: 1/8" = 1' NOVEMBER 11, 2008

REVISED: 12-13-05 FINAL REVISIONS.

0 8 16 24

SCALE

WEST END MAIN FLOOR - UNIT 25

EAST END AND WEST END COMBINED AREA 7,972± s.f.

CONDOMINIUM FLOOR PLAN

NEWMARKET CONDOMINIUM

LOCATED AT

19-25 HOWARD STREET

140 HAMPDEN STREET

ROXBURY, BOSTON, MASS.

BY

Otte & Dwyer, Jr.

LAND SURVEYORS

196 CENTRAL STREET SAUGUS, MASS.

P.O. BOX 982 (781) 233-8155

SCALE: 1/8" = 1' NOVEMBER 11, 2008

REVISED: 12-13-05 FINAL REVISIONS.

0 8 16 24

SCALE

WEST END MAIN FLOOR - UNIT 25

EAST END AND WEST END COMBINED AREA 7,972± s.f.

CONDOMINIUM FLOOR PLAN

NEWMARKET CONDOMINIUM

LOCATED AT

19-25 HOWARD STREET

140 HAMPDEN STREET

ROXBURY, BOSTON, MASS.

BY

Otte & Dwyer, Jr.

LAND SURVEYORS

196 CENTRAL STREET SAUGUS, MASS.

P.O. BOX 982 (781) 233-8155

SCALE: 1/8" = 1' NOVEMBER 11, 2008

REVISED: 12-13-05 FINAL REVISIONS.

0 8 16 24

SCALE

WEST END MAIN FLOOR - UNIT 25

EAST END AND WEST END COMBINED AREA 7,972± s.f.

CONDOMINIUM FLOOR PLAN

NEWMARKET CONDOMINIUM

LOCATED AT

19-25 HOWARD STREET

140 HAMPDEN STREET

ROXBURY, BOSTON, MASS.

BY

Otte & Dwyer, Jr.

LAND SURVEYORS

196 CENTRAL STREET SAUGUS, MASS.

P.O. BOX 982 (781) 233-8155

SCALE: 1/8" = 1' NOVEMBER 11, 2008

REVISED: 12-13-05 FINAL REVISIONS.

0 8 16 24

SCALE

WEST END MAIN FLOOR - UNIT 25

EAST END AND WEST END COMBINED AREA 7,972± s.f.

CONDOMINIUM FLOOR PLAN

NEWMARKET CONDOMINIUM

LOCATED AT

19-25 HOWARD STREET

140 HAMPDEN STREET

ROXBURY, BOSTON, MASS.

BY

Otte & Dwyer, Jr.

LAND SURVEYORS

196 CENTRAL STREET SAUGUS, MASS.

P.O. BOX 982 (781) 233-8155

SCALE: 1/8" = 1' NOVEMBER 11, 2008

REVISED: 12-13-05 FINAL REVISIONS.

0 8 16 24

SCALE

WEST END MAIN FLOOR - UNIT 25

EAST END AND WEST END COMBINED AREA 7,972± s.f.

CONDOMINIUM FLOOR PLAN

NEWMARKET CONDOMINIUM

LOCATED AT

19-25 HOWARD STREET

140 HAMPDEN STREET

ROXBURY, BOSTON, MASS.

BY

Otte & Dwyer, Jr.

LAND SURVEYORS

196 CENTRAL STREET SAUGUS, MASS.

P.O. BOX 982 (781) 233-8155

SCALE: 1/8" = 1' NOVEMBER 11, 2008

REVISED: 12-13-05 FINAL REVISIONS.

0 8 16 24

SCALE

WEST END MAIN FLOOR - UNIT 25

EAST END AND WEST END COMBINED AREA 7,972± s.f.

CONDOMINIUM FLOOR PLAN

NEWMARKET CONDOMINIUM

LOCATED AT

19-25 HOWARD STREET

140 HAMPDEN STREET

ROXBURY, BOSTON, MASS.

BY

Otte & Dwyer, Jr.

LAND SURVEYORS

196 CENTRAL STREET SAUGUS, MASS.

P.O. BOX 982 (781) 233-8155

SCALE: 1/8" = 1' NOVEMBER 11, 2008

REVISED: 12-13-05 FINAL REVISIONS.

0 8 16 24

SCALE

WEST END MAIN FLOOR - UNIT 25

EAST END AND WEST END COMBINED AREA 7,972± s.f.

CONDOMINIUM FLOOR PLAN

NEWMARKET CONDOMINIUM

LOCATED AT

19-25 HOWARD STREET

140 HAMPDEN STREET

ROXBURY, BOSTON, MASS.

BY

Otte & Dwyer, Jr.

LAND SURVEYORS

196 CENTRAL STREET SAUGUS, MASS.

P.O. BOX 982 (781) 233-8155

SCALE: 1/8" = 1' NOVEMBER 11, 2008

REVISED: 12-13-05 FINAL REVISIONS.

0 8 16 24

SCALE

WEST END MAIN FLOOR - UNIT 25

EAST END AND WEST END COMBINED AREA 7,972± s.f.

CONDOMINIUM FLOOR PLAN

NEWMARKET CONDOMINIUM

LOCATED AT

19-25 HOWARD STREET

140 HAMPDEN STREET

ROXBURY, BOSTON, MASS.

BY

Otte & Dwyer, Jr.

LAND SURVEYORS

196 CENTRAL STREET SAUGUS, MASS.

P.O. BOX 982 (781) 233-8155

SCALE: 1/8" = 1' NOVEMBER 11, 2008

REVISED: 12-13-05 FINAL REVISIONS.

0 8 16 24

SCALE

WEST END MAIN FLOOR - UNIT 25

EAST END AND WEST END COMBINED AREA 7,972± s.f.

CONDOMINIUM FLOOR PLAN

NEWMARKET CONDOMINIUM

LOCATED AT

19-25 HOWARD STREET

140 HAMPDEN STREET

ROXBURY, BOSTON, MASS.

BY

Otte & Dwyer, Jr.

LAND SURVEYORS

196 CENTRAL STREET SAUGUS, MASS.

P.O. BOX 982 (781) 2

I HEREBY CERTIFY THAT THIS PLAN FULLY AND ACCURATELY DEPICTS THE LAYOUT, LOCATION AND NAME OF THE "NEWMARKET CONDOMINIUM" AS BUILT AND FULLY LISTS THE UNITS (25 & 140) CONTAINED THEREIN.

Walter C. Sawyer, Inc.
 PROFESSIONAL LAND SURVEYOR
 FOR OTTE & DWYER, INC.

THIS PLAN WAS PREPARED IN ACCORDANCE WITH THE RULES AND REGULATIONS FOR RECORDS AS ADOPTED BY THE REGISTER OF DEEDS IN 1978 AND AMENDED JANUARY 12, 1988.

Walter C. Sawyer, Inc.
 PROFESSIONAL LAND SURVEYOR
 FOR OTTE & DWYER, INC.

THIS PLAN WAS PREPARED IN ACCORDANCE WITH THE RULES AND REGULATIONS FOR RECORDS AS ADOPTED BY THE REGISTER OF DEEDS IN 1978 AND AMENDED JANUARY 12, 1988.

Walter C. Sawyer, Inc.
 PROFESSIONAL LAND SURVEYOR
 FOR OTTE & DWYER, INC.

CONDOMINIUM SITE PLAN
NEWMARKET CONDOMINIUM
 LOCATED AT
 19-25 HOWARD STREET
 140 HAMPDEN STREET
 ROXBURY, BOSTON, MASS.

BY
Walter C. Sawyer, Inc.

LAND SURVEYORS
 184 CENTRAL STREET
 P.O. BOX 982
 SAUGUS, MASS. (781) 233-8155
 SCALE: 1"=20'
 NOVEMBER 10, 2005
 REVISION: 12-13-05, ADD FINAL REVISIONS

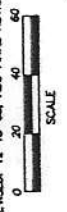

JN 10454

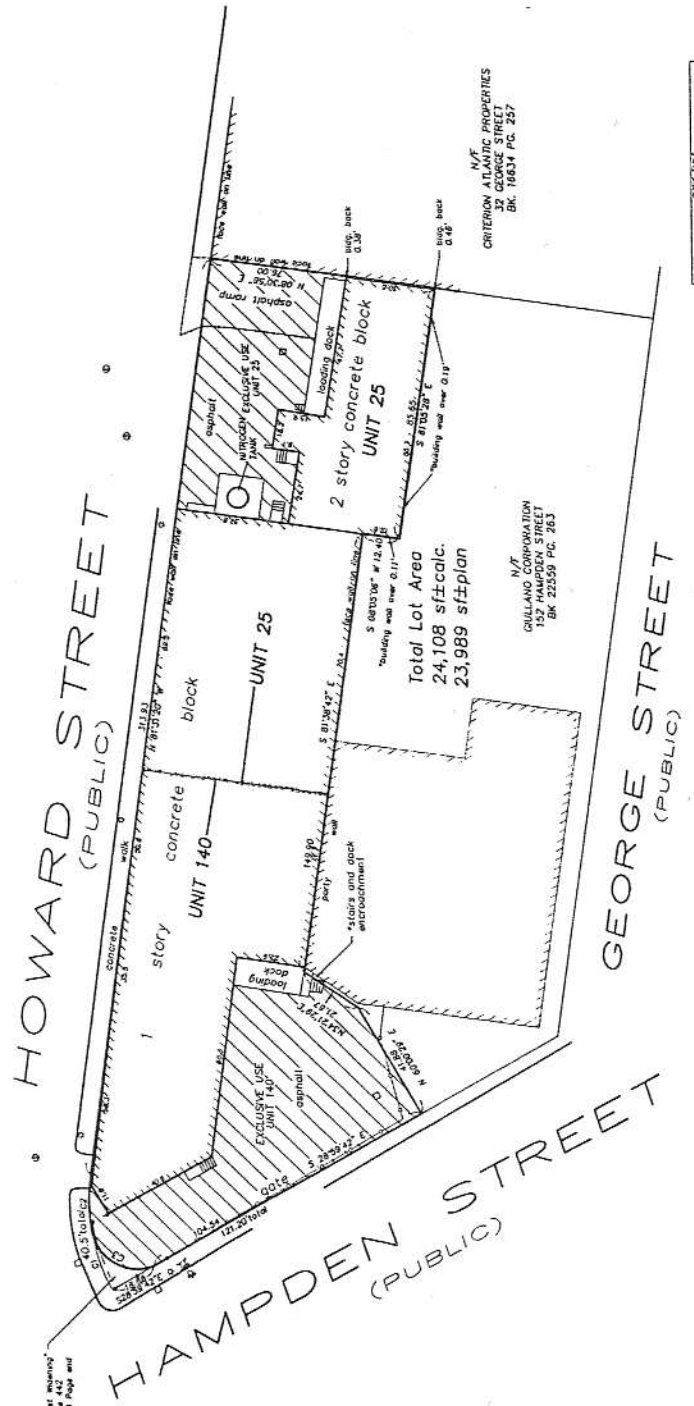

CURVE	CHORD	ANGLE	MARKS
C1	21.38'	63.87°	
C2	18.84'	63.87°	
C3	28.19'	78.00°	

LEGEND

- CHAIN LINK FENCE
- CONCRETE
- EXCLUSIVE USE
- GRASS
- HYDRAV. CATCH BASIN
- IRON PIPE
- LIGHT POLE
- ROLLBAR

"Newmarket Condominium"
 Book 1177 Page 442
 Plan Book 8139 Page 441